



PANDA EXPRESS, INC.  
1683 Walnut Grove Ave.  
Rosemead, California  
91770  
Telephone: 626.799.9898  
Facsimile: 626.372.8288

All ideas, designs, arrangement and plans indicated or represented by this drawing are the property of Panda Express Inc. and were created for use on this specific project. None of these ideas, designs, arrangements or plans may be used by or disclosed to any person, firm, or corporation without the written permission of Panda Express Inc.

REVISIONS:		
ISSUE DATE:		
1	BID SET	2023-05-02

DRAWN BY:

PANDA PROJECT #: S4-24-D22020  
ARCH PROJECT #: P7377



www.cphcorp.com  
**A Full Service  
A & E Firm**

Plans Prepared By  
**CPL, LLC**  
500 West Fulton St.  
Sanford, FL 32771  
Ph: 407.322.6841  
Licenses:  
Eng. C.O.A. No. 3215  
Survey L.B. No. 7143  
Arch. Lic. No. AA2600926  
Lndscp. Lic. No. LC0000298

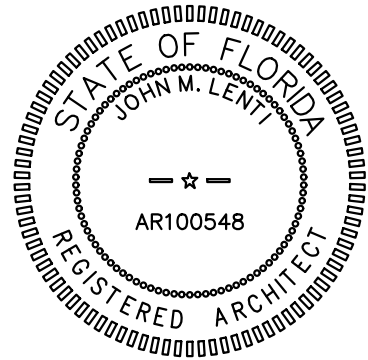

PANDA EXPRESS  
PANDA END CAP  
3301 W HILLSBORO BLVD  
DEERFIELD BEACH, FL 33442

A-102

ROUGH - IN PLUMBING PLAN

PANDA HOME 2600 R4/DAB

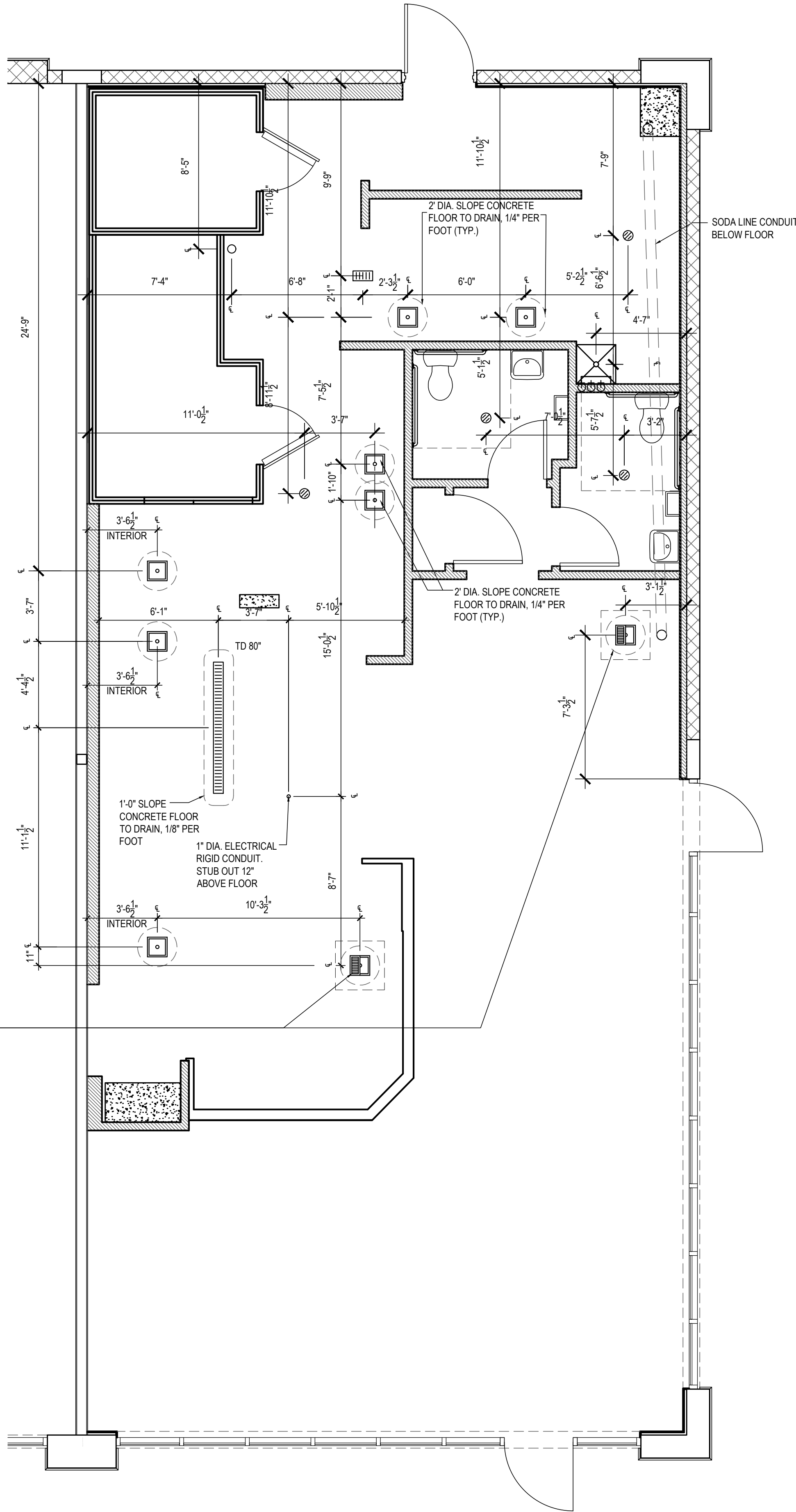

NOTE:  
PROVIDE 2'-6" X 2'-6" LEAVE OUT  
AROUND FLOOR SINK SHOWN TO  
ALLOW FOR FINAL ADJUSTMENT.  
PROVIDE #3 DOWELS @ 12" O.C.  
AROUND PERIMETER. (THESE 2  
SINKS ONLY.)

