

BK 26 Pg 85

CORNER RECORD

Document Number CR 3062

City of OAKLAND

County of ALAMEDA, California

Brief Legal Description WELL MONUMENT LOCATED WITHIN THE INTERSECTION  
OF EAST 12TH STREET AND 10TH AVENUE. (17/A/15)

CORNER RECORD

Government Corner ☐ Control ☒  
Meander ☐ Property ☐  
Rancho ☐ Other ☐  
Date of Survey 05-11-07

COORDINATES  
(Optional)

N. \_\_\_\_\_  
E. \_\_\_\_\_  
Zone \_\_\_\_\_ Datum \_\_\_\_\_  
Elev. \_\_\_\_\_

Corner — Left as found ☒ Found and tagged ☐ Established ☐ Reestablished ☐ Rebuilt ☐

Identification and type of corner found: Evidence used to identify or procedure used to establish or reestablish the corner:

FOUND BRASS DISC IN WELL MONUMENT LOCATED IN THE INTERSECTION

OF EAST 12TH STREET AND 10TH AVENUE. AS SHOWN ON OAKLAND

MONUMENT MAP, PG 167.

THIS POINT WAS REFERENCED PRIOR TO A CONSTRUCTION

PROJECT IN THE VICINITY.

A description of the physical condition of the monument as found and as set or reset: \_\_\_\_\_

FOUND AND SET POINTS AS SHOWN ON PAGE 2.

SURVEYOR'S STATEMENT

This Corner Record was prepared by me or under my direction in conformance with  
the Land Surveyors' Act on MAY 24, 20 07.

Signed Vincent H. Cunha L.S. Number LS 4520  
VINCENT H. CUNHA

COUNTY SURVEYOR'S STATEMENT

This Corner Record was received 6-4-2007 and examined

and filed 9-9-2007

Signed Russell R. Penland, Jr. Title COUNTY SURVEYOR

County Surveyor's Comment \_\_\_\_\_

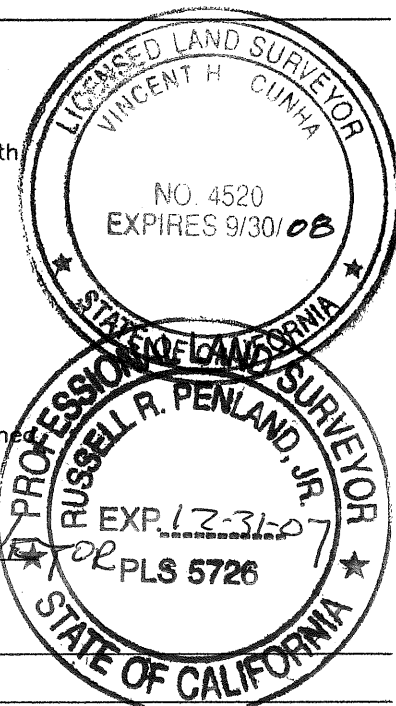

# LEGEND

- FOUND STANDARD STREET MONUMENT (17/A/15)
- ✕ FOUND CUT CROSS
- ⌘ SET NAIL AND TAG LS 4520

