

CORNER RECORD

Agency Index

BK 97 PG 76

Document Number

CR 10212

City of HaywardCounty of Alameda

, California

Brief Legal Description

Mon @ NE Corner of Via Esperanza

CORNER TYPE

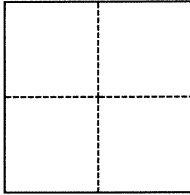

- ☐ Government Corner ☒ Control
☐ Meander ☐ Property
☐ Rancho ☐ Other

Date of Survey 5-30-17

COORDINATES (Optional)

N. 2069693.72 E. 6090363.96Elevation —

Units

☐ Metric☒ U.S. Survey FootHorizontal Datum —Zone 3Epoch Date —Vertical Datum —☐ Complies with Public Resources Code §§8801-8819☐ Complies with Public Resources Code §§8890-8902

PLS Act Ref.:

☐ 8765(d)☒ 8771☐ 8773☐ Other:Corner/
Monument:☒ Left as found☐ Established☐ Rebuilt☒ Pre-Construction☐ Found and tagged☐ Reestablished☐ Referenced☐ Post-Construction

Narrative of corner identified and monument as found, set, reset, replaced, or removed:

☐ See sheet #2 for description(s):City Monument

SURVEYOR'S STATEMENT

This Corner Record was prepared by me or under my direction in conformance with

the Professional Land Surveyors' Act on

Signed

Joseph M. Brajkovich

P.L.S. or R.C.E. No.

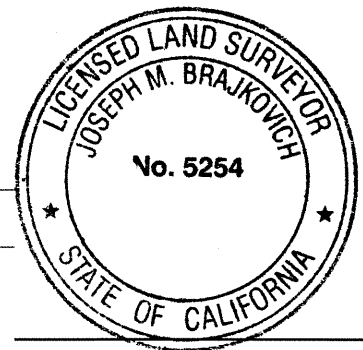
5254

COUNTY SURVEYOR'S STATEMENT

This Corner Record was received

23 JUNE, 2017

and examined and filed

8 AUGUST, 2017

Signed

Michael Rubner

P.L.S. or R.C.E. No.

6843

Title

COUNTY SURVEYOR

County Surveyor's Comment

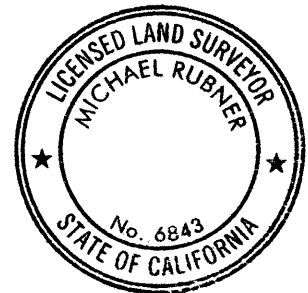

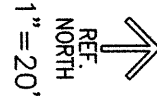

LEGEND

- MONUMENT
- CUT X

