

1. VERIFY ALL HVAC & KITCHEN EQUIPMENT PRIOR TO ROUGH IN.
2. ALL TELEPHONE/DATA/TV CABLES AND WIRES, AND TERMINATES ALL REQUIRED CABLE AND JACKS WILL BE INSTALLED BY THIRD PARTY.
3. POWER SUPPLY FOR COMPUTER, CASH REGISTER (81, & 86, OR 87A, & 81) SHALL BE ON THE SAME CIRCUIT BREAKER, W/ISOLATED GROUND & ORANGE RECEPTACLE.
4. ALL CIRCUITRY SHOWN WITHOUT TICKS SHALL HAVE (2) WIRES PLUS EQUIPMENT GROUNDING CONDUCTOR.
5. WHEN WORKING IN JURISDICTIONS WHICH HAVE ADOPTED THE 2008 NEC OR LATER, ALL MULTI-WIRE BRANCH CIRCUITS SHALL HAVE SEPARATE NEUTRALS TO MEET THE REQUIREMENTS OF 2008 NEC 210.4(B).
6. NOT USED.

POWER PLAN GENERAL NOTES 2

NOT TO SCALE E-100

1. ALL CIRCUITRY/CONDUIT FOR FRONT LINE EQUIPMENT TO BE ROUTED IN CASEWORK TO J-BOX IN WALL AND CONCEAL IN WALL.
2. PROVIDE SEALS AND EXPANSION COUPLINGS ON ALL CONDUITS ENTERING / LEAVING AREA OF TEMPERATURE DIFFERENCE.
3. PROVIDE (2) 1" CONDUITS WITH PULL STRINGS FROM CASH REGISTER TO MANAGER STATION. SEE P.O.S. AND SERVICE LINE ELEVATIONS, SHEET 3/E-200. UTILIZE RIGID CONDUIT ONLY, NO FLEX PERMITTED.
4. SEE 'MANAGER STATION ELEVATION' 1 / E-200.
5. ANSUL PULL STATION. REFER TO DETAIL, SHEET 2 / E-400.
6. REFER TO 'LTG AND DOOR HEATER' WIRING DIAGRAM, SHEET 10 / E-400.
7. REFER TO 'COOLER EVAPORATOR COIL' WIRING DIAGRAM, SHEET 8 / E-400.
8. CONNECT HEAT LAMPS TO COUNTER-MOUNTED SWITCH PROVIDED AND INSTALLED BY CONTRACTOR. REFER TO PLAN FOR LOCATIONS AND QUANTITIES.
9. W.P. J-BOX FOR SIGNAGE. COORDINATE LOCATION WITH ARCHITECT / OWNER / SIGN PACKAGE. SIGN DISCONNECT PROVIDED BY SIGN CONTRACTOR.
10. REFER TO 'FREEZER EVAPORATOR COIL' WIRING DIAGRAM, SHEET 9 / E-400. CONNECTION FOR HEAT TRACE TAPE INCLUDED IN FREEZER EVAPORATOR COIL. HEAT TAPE PROVIDED AND INSTALLED BY ELECTRICIAN.
11. SEE 3/E-200 FOR SERVICE LINE ELEVATIONS.
12. CONNECT HEAT LAMPS TO COUNTER-MOUNTED SWITCH PROVIDED AND INSTALLED BY CONTRACTOR. REFER TO PLAN FOR LOCATIONS AND QUANTITIES.
13. NOT USED.
14. HOOD CONTROL PANEL/ANSUL SYSTEM CABINET. MOUNT CABINET DIRECTLY BELOW T-BAR CEILING.
15. PROVIDE 2-GANG J-BOX @ 48" AFF FOR HOOD CONTROL PANEL. REFER TO M-400, M-401 AND M-402.
16. CONDUIT STUB UP LOCATION IN STAINLESS STEEL POWER PANEL FOR ISLAND KITCHEN EQUIPMENT CONNECTION. REFER TO DETAIL 2/A-109. COORDINATE LOCATION WITH ARCHITECT / OWNER.
17. ROUTE CABLING / CIRCUITRY THROUGH CONDUIT IN SLAB (KEYED NOTE #16).
18. PROVIDE WP, IN-USE RED DOT (#CKSUV).
19. ALL DEVICES UNDER HOOD TO BE PROVIDED AND INSTALLED WITH SHUNT TRIP CIRCUIT BREAKER AND WATERPROOFING BOX (RED DOT #CKSUV). REFER TO COOKLINE ELECTRICAL ELEVATIONS, SHEET 6/E-200.
20. ELECTRIC GRILL '23B': FEED WITH 3 #8, #10 GROUND, 3/4" CONDUIT. REFER TO DETAIL, SHEET 4 / E-200.
21. DRIVE-THRU SENSOR LOOP. COORDINATE LOCATION. REFER TO DETAIL 1 / E-401.
22. STUB-UP FOR DRIVE-THRU ORDER CONFIRMATION MONITOR. COORDINATE LOCATION WITH ARCHITECT / OWNER.
23. PROVIDE 3/4" CONDUIT FOR OPTIONAL SPEAKER WITH PULL STRING.

POWER PLAN KEYED NOTES 3

NOT TO SCALE E-100

NO UNDER SLAB ELECTRICAL WORK ALLOWED UNLESS OTHERWISE NOTED ON PLAN.

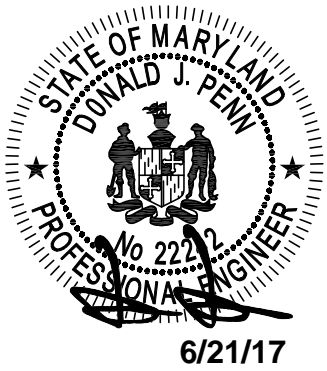
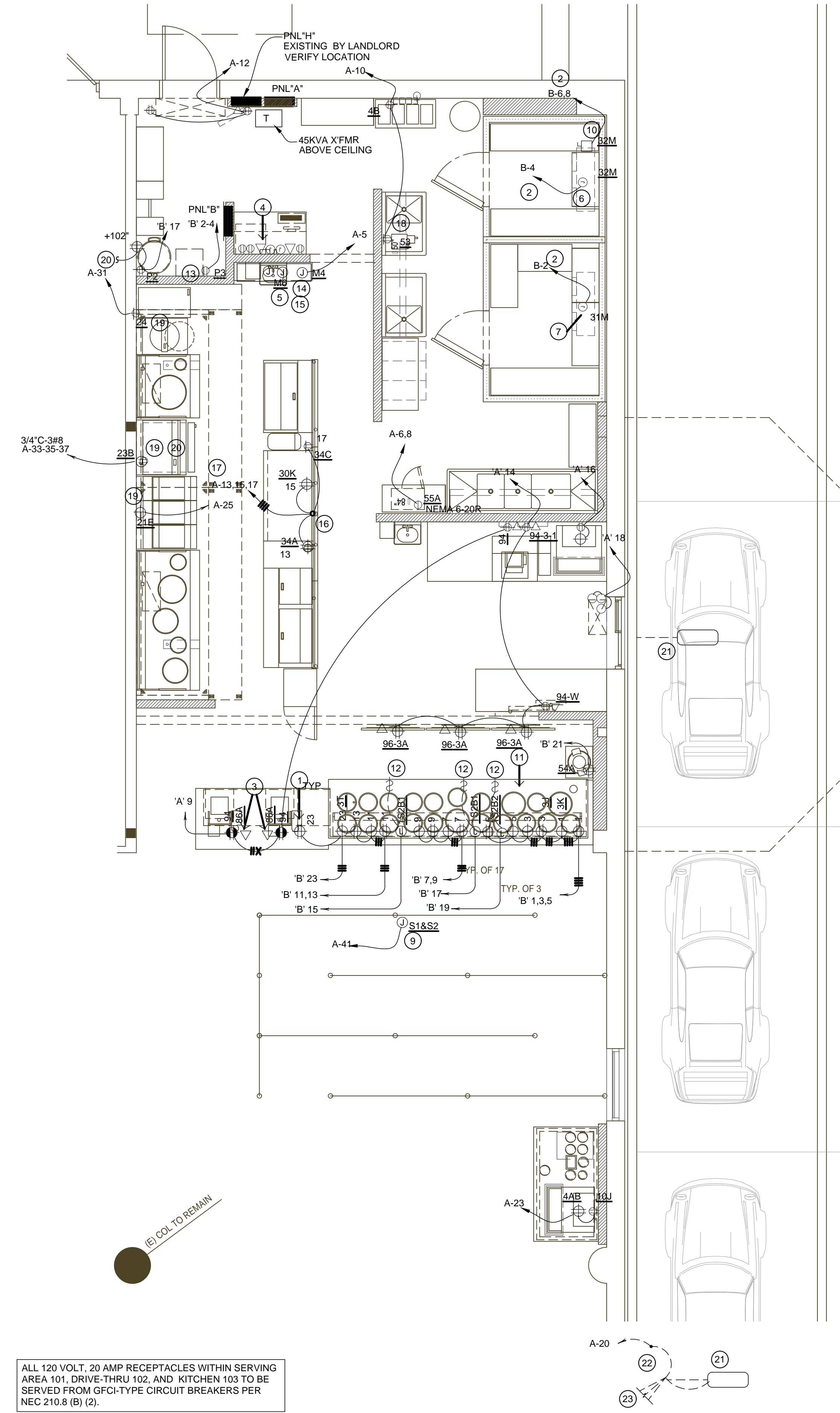

POWER FLOOR PLAN 1

Scale: 1/4"=1'-0" E-100



PANDA RESTAURANT GROUP INC.  
1683 Walnut Grove Ave.  
Rosemead, California  
91770  
Telephone: 626.799.9898  
Facsimile: 626.372.8288

All ideas, designs, arrangement and plans indicated or represented by this drawing are the property of Panda Express Inc. and were created for use on this specific project. None of these ideas, designs, arrangements or plans may be used by or disclosed to any person, firm, or corporation without the written permission of Panda Express Inc.

REVISIONS:

ISSUE DATE:

1	100% SUBMITTAL

CHECKED BY:  
DRAWN BY: STAFF

PANDA PROJECT #: B1-17-D5167  
ARCH PROJECT #:

**d p c e**  
don penn • consulting engineer  
1301 SOLANA BLVD., BLDG. 1,  
SUITE 1420  
WESTLAKE, TEXAS 76262  
Phone: 817-410-2858  
Fax: 817-251-8411

Professional Certification

I hereby certify that these documents were prepared or approved by me, and that I am a duly licensed professional engineer under the laws of the State of Maryland. License number 22242, Expiration Date: 02/03/19

PANDA EXPRESS

NAS PAX RIVER  
PAX RIVER NAVY BASE  
PATUXENT RIVER, MD

E-100

POWER FLOOR PLAN

CONSTRUCTION SET - 2017/07/30